

# Technisches Detail:

## Gefällekeil links

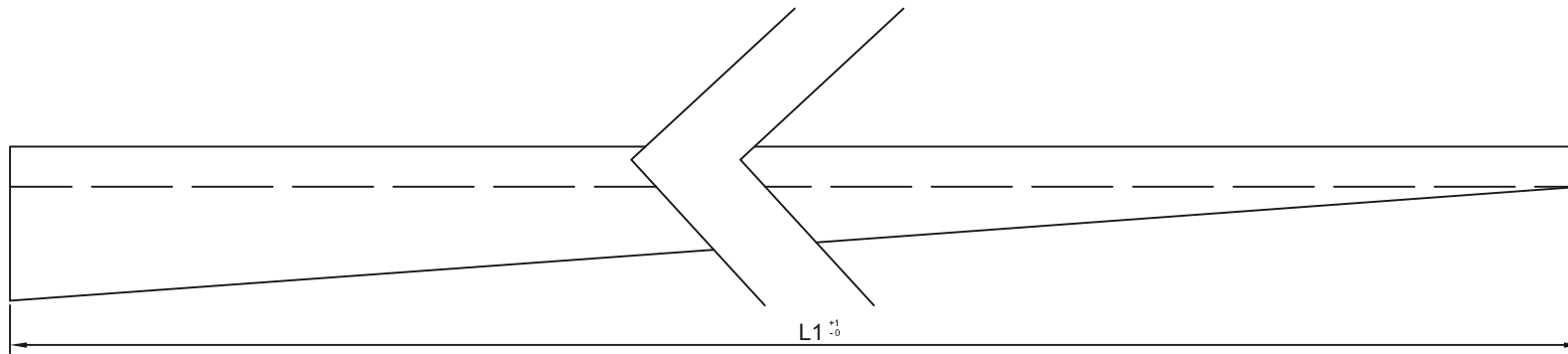

Querschnitt vorn

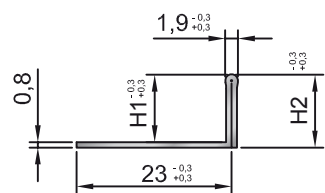

Querschnitt hinten

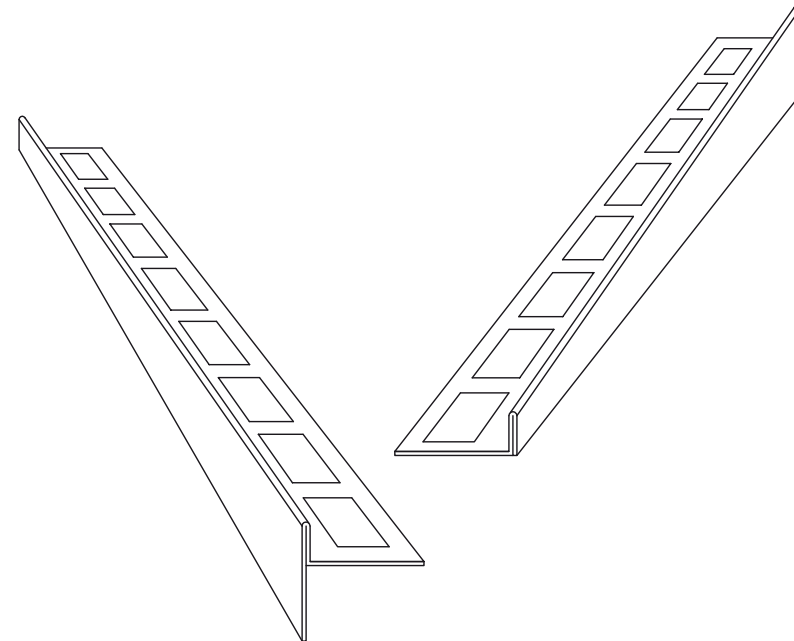
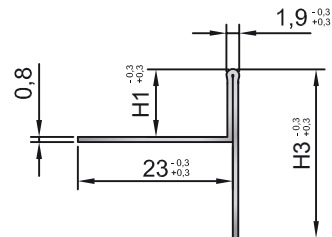

L1/Länge	H1/Höhe vorn	H2/Höhe vorn	H3/Höhe hinten
1000 mm	8,0 / 10,0 / 12,5 mm	8,8 / 10,8 / 13,3 mm	25 mm
1500 mm	8,0 / 10,0 / 12,5 mm	8,8 / 10,8 / 13,3 mm	33 mm